

MQN-C

Montage/Assembly/Montage:

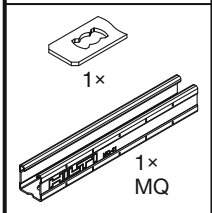
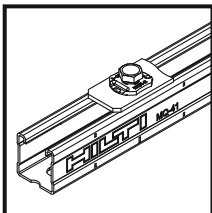

Channel I*

25 Nm
T_{inst}
(18 ft-lb)



Channel II*

40 Nm
T_{inst}
(30 ft-lb)



*Channel I: MQ-21.5 / MQ-41-L / MQ-41D-L Channel II: andere MQ Schienen / other MQ Channels / autres rails MQ

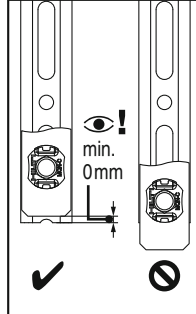
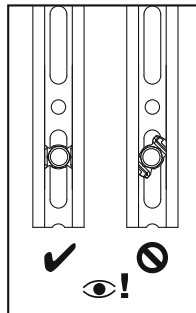
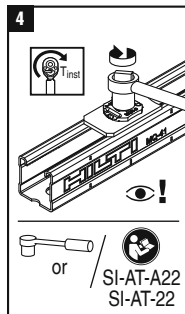
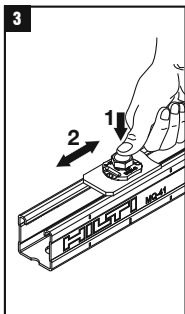
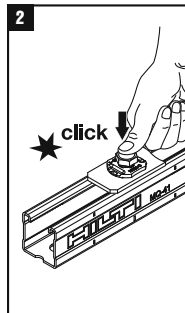
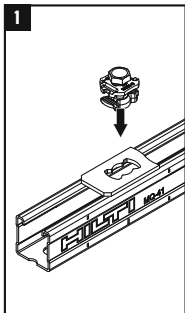

Demontage/Disassembly/
Démontage:

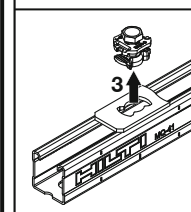
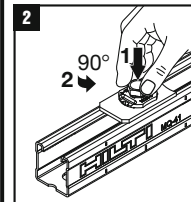
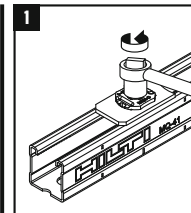

2190668-12.2022